



Davies Court, Hythe Road, Worthing, BN11 5DQ
Asking Price £240,000



We are pleased to be able to offer a top floor, purpose built apartment to the market. The property offers two bedrooms, south facing lounge, south facing balcony, kitchen and bathroom. The property benefits from being just a short walk away from Worthing Seafront, chain free and being sold with a long lease.



Key Features

- Top Floor Apartment
- Two Bedrooms
- South Facing Lounge
- South Facing Balcony
- Fitted Kitchen
- Bathroom
- Long Lease
- Sea Glimpse
- Close To Worthing Seafront
- Bus Routes Nearby On Grand Avenue



2 Bedrooms



1 Bathrooms



1 Reception Rooms

INTERNAL

Communal front door with stairs rising to the second floor. Front door opening into the entrance hall with access to all rooms. The property offers a south facing lounge with door leading out to the south facing balcony. The kitchen offers fitted units with built in oven, hob and spaces for washing machine and fridge/ freezer. The apartment benefits from two bedrooms with the primary bedroom measuring 12'7ft x 11'9ft. The bathroom offers bath with shower above, wash hand basin and WC.

EXTERNAL

To the front of the property there is non allocated parking. The property offers a south facing balcony with sea glimpses and views over the communal gardens.

LOCATION

On Hythe Road in a highly sought after position in West Worthing within 200 metres from Worthing Seafront. Local shops can be found at Heene Road and Goring Road, both of which are approximately half a mile away. Worthing Town Centre with its comprehensive shopping amenities, restaurants, pubs, cinemas, theatres and leisure facilities is within a mile. The nearest station is West Worthing which is less than a mile away and bus services run nearby on Grand Avenue.

TENURE

Leasehold

Lease:985 years remaining

Service Charge:

Ground Rent:



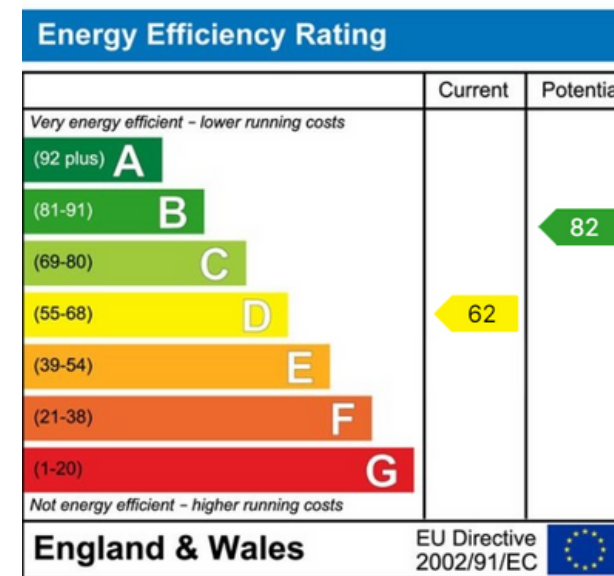
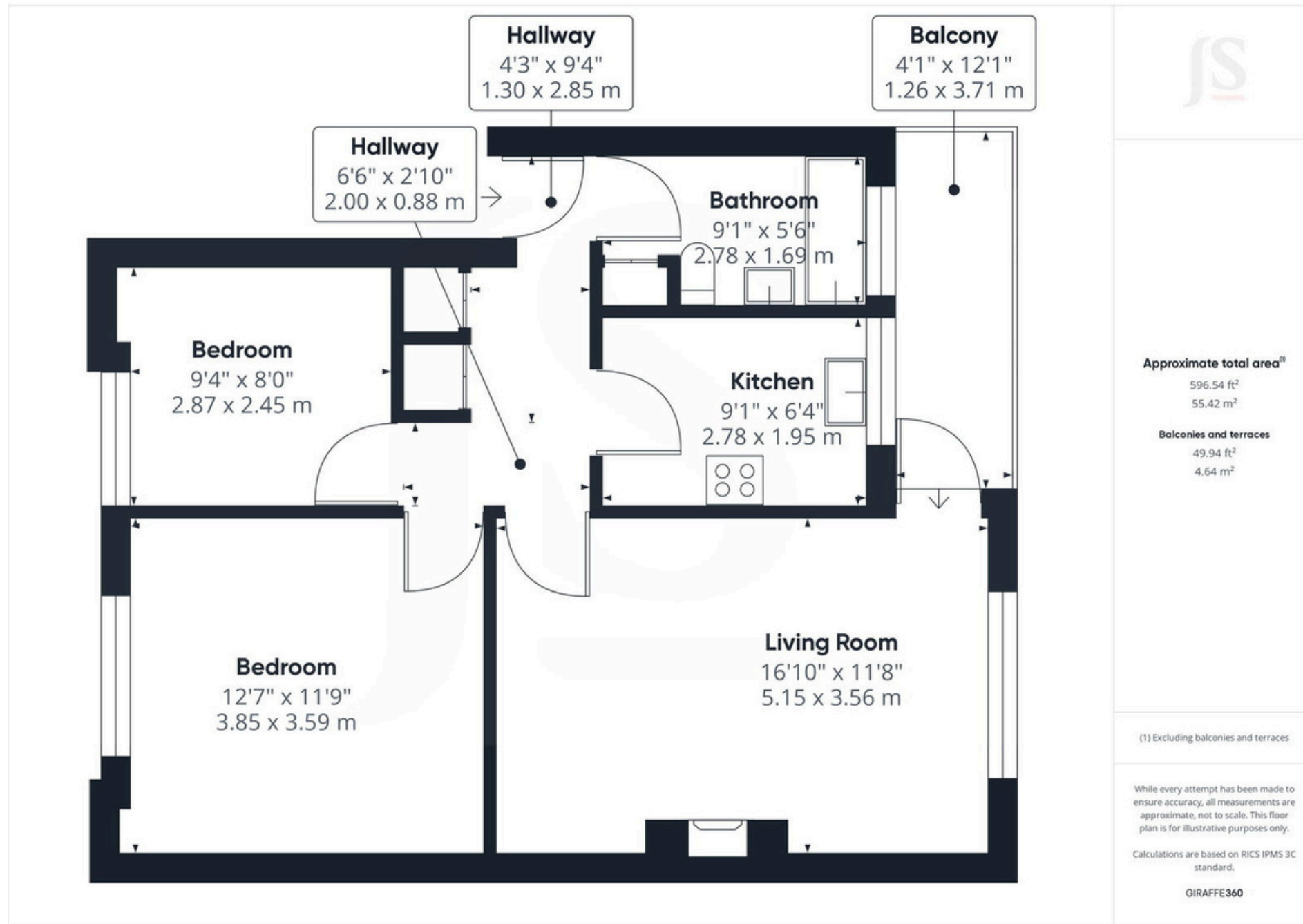

Property Details:

Floor area (as quoted by EPC: TBC sqm)

Tenure: Leasehold

Council tax band: B

Whilst we endeavour to make our property particulars accurate and reliable, we have not carried out a detailed survey. If there is any point which is of particular importance to you, please contact the office and we will be pleased to check the information for you, particularly if you are contemplating travelling some distance. Whilst every effort has been made to ensure that any floorplans are correct and drawn as accurately as possible, they are to be used for layout and identification purposes only and are not drawn to scale. The services, where applicable, including electrical equipment and other appliances have not been tested and no warranty can be given that they are in working order, even where described in these particulars. Carpets, curtains, furnishings, gas fires, electrical goods/fittings or other fixtures, unless expressly mentioned, are not necessarily included with the property.