



38 Crabtree Lane | Lancing | BN15 9PQ
Asking Price Of **£99,950**

A lock up shop located on a secondary shopping parade in Lancing. Currently let at £6600 pa.

Property details: 38 Crabtree Lane | Lancing | BN15 9PQ

Key features:

- Lock up shop

-
-
-
-
-
-
-
-
-
-

 0 Bedrooms

 0 Bathrooms

 0 Living Room

A lock up shop located on a secondary shopping parade in Lancing. Currently let at £6600 pa.

GROUND FLOOR

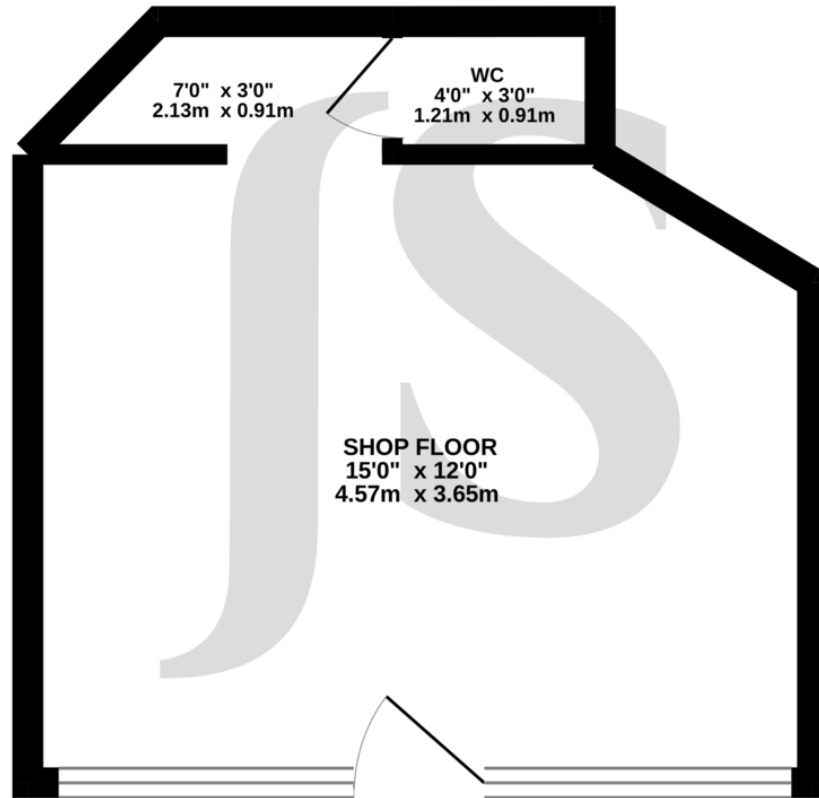

%epcGraph_c_1_330%

Property Details:

Floor Area: () – Floor area is quoted from the EPC

Tenure: Freehold

Council Tax: Band

Whilst we endeavour to make our property particulars accurate and reliable, we have not carried out a detailed survey. If there is any point which is of particular importance to you, please contact the office and we will be pleased to check the information for you, particularly if you are contemplating travelling some distance. Whilst every effort has been made to ensure that any floorplans are correct and drawn as accurately as possible, they are to be used for layout and identification purposes only and are not drawn to scale. The services, where applicable, including electrical equipment and other appliances have not been tested and no warranty can be given that they are in working order, even where described in these particulars. Carpets, curtains, furnishings, gas fires, electrical goods/ fittings or other fixtures, unless expressly mentioned, are not necessarily included with the property.