



Tamworth Road | Hove | BN3 5FH
Guide Price **£575,000 - £600,000**





**** Guide Price £575,000 - £600,000 **** Three-bedroom Victorian terraced house located in the heart of Hove's popular Poets Corner. Traditional features throughout including large bay windows. Open plan living and west facing garden.



Key features:

- ** Guide Price £575,000 - £600,000 **
- Three Double Bedrooms
- West Facing Garden
- Victorian Home
- Poets Corner Location
- Close to Hove Station

 3 Bedrooms

 1 Bathroom

 1 Living Room

INTERNAL Arranged over two, the property comprises of an open plan reception room with some beautiful features. At the rear of the property there is a large Kitchen / diner with ample space for dining and with access out to the private rear garden.

On the first floor there are three great sized double bedrooms and a family bathroom.

EXTERNAL Easy to maintain west facing rear garden which is mainly laid with hard paving. Fence enclosed.

LOCATION Situated on a sought after residential street in the desirable Poets Corner area. Located near Portland Road which hosts a wide variety of different shops, pubs and restaurants. The popular Flour Pot Bakery (located just 0.3 miles from your doorstep), and 44 Poets Café which serve a delicious coffee (also located just 0.3 miles away). Bus routes are very frequent and have many links into Brighton. Approximately 0.3 miles to Aldrington Train Station and just a brisk walk from Hove Seafront.



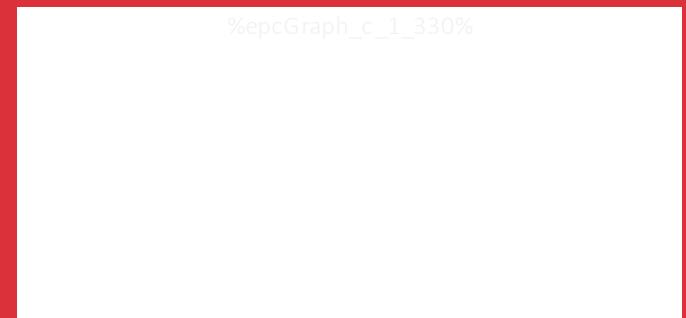
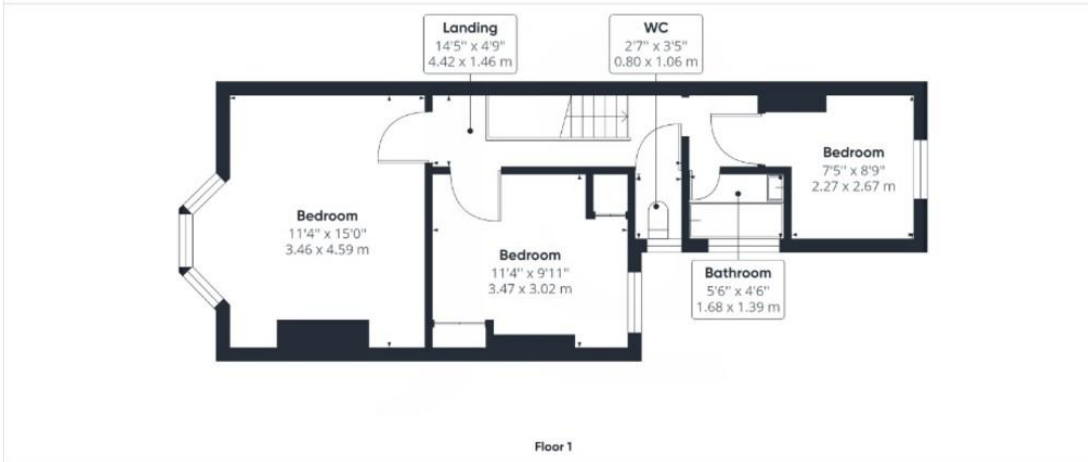
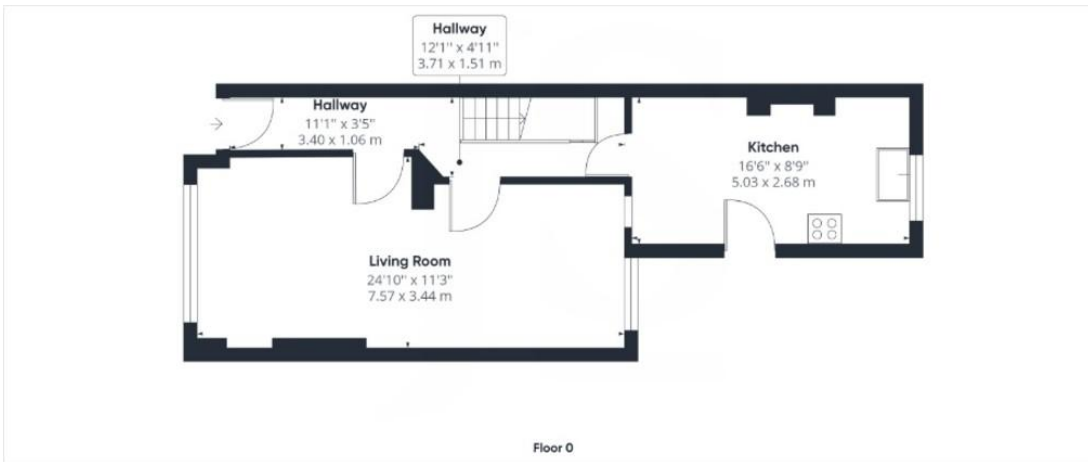

(1) Excluding balconies and terraces

While every attempt has been made to ensure accuracy, all measurements are approximate, not to scale. This floor plan is for illustrative purposes only.

GIRAFFE360

Property Details:

Floor Area: (93 SQM) – Floor area is quoted from the EPC

Tenure: Freehold

Whilst we endeavour to make our property particulars accurate and reliable, we have not carried out a detailed survey. If there is any point which is of particular importance to you, please contact the office and we will be pleased to check the information for you, particularly if you are contemplating travelling some distance. Whilst every effort has been made to ensure that any floorplans are correct and drawn as accurately as possible, they are to be used for layout and identification purposes only and are not drawn to scale. The services, where applicable, including electrical equipment and other appliances have not been tested and no warranty can be given that they are in working order, even where described in these particulars. Carpets, curtains, furnishings, gas fires, electrical goods/ fittings or other fixtures, unless expressly mentioned, are not necessarily included with the property.